

OPERATING INSTRUCTIONS

PRODUCT TYPE

2- & 3-ARM COMBI PULLERS /
SLIDEHAMMER

MODELS

8466-0001 / 8467-0001 / 8471-0001



1. Make sure that the spindle is perfectly clean and greased
2. Make sure the jaws are perfectly centred.
3. Use all necessary personal protective equipment (PPE).

INTERNAL

EXTERNAL

Insert the puller into the collet.

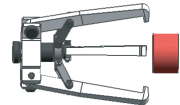
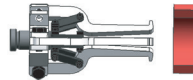

Turn the spindle until the jaws are adjusted.

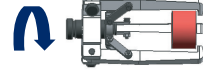
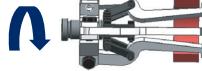
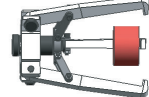
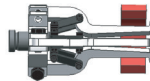

Mount the slide hammer.



Tap with the hammer until it is extracted.

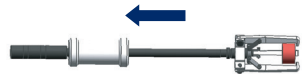
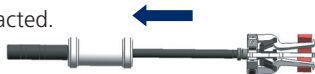

In internal applications of diameter > 60 mm it is better to work with the inverted external jaw.

