

TORQUE WRENCH CALIBRATION MANUAL

PRODUCT TYPE

TORQUE WRENCH CLICK-TYPE

MODEL

7114-1025
7138-1050
7138-1100
7112-1200
7112-1340
7134-1550
7134-1750



Prepare:

Torque wrench, 2.5 mm hexagon key and a torque tester (before recording data, pre-operate in order to warm up the structure).

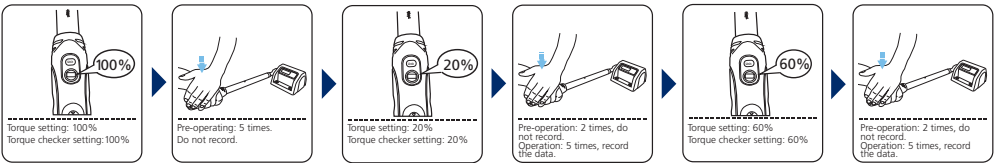

Notice: If the torque data is not in the tolerance ($\pm 4\%$) after adjusting; contact your dealer or send the torque wrench back for further calibration.

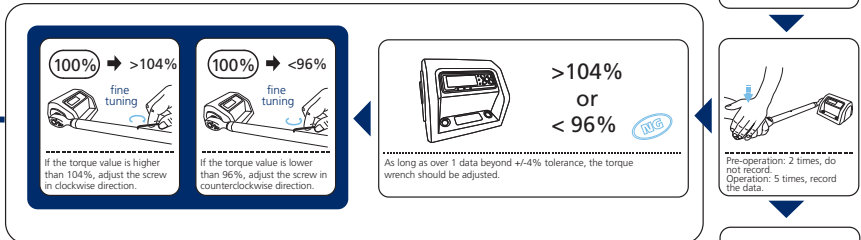

Calibration process of the torque wrench

